

Juggernaut.Case™ HAHO-L User Instructions



1 for LED removal pull up toward user to snap out of mount



2 insert LED end into tunnel and push back end in to snap back into place



3 remove Garmin from wrist strap if not already loose and re-install the screw opposite the buttons with supplied driver



4 align Garmin with tunnel on HAHO-L

refer to Garmin user manual for operating instructions



5 re-install screw on button side of Garmin once aligned

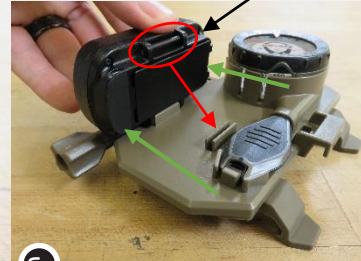

6 snap feature allows Garmin to rotate up providing access to the battery door and USB port



7 the unit articulates around the hinge and can be locked into position using the knob



8 turn on the LED by pressing down on the pad on top of the unit

1st Click – High 2nd Click – Low
3rd Click – Flash 4th Click – Off

Juggernaut.Case™
smartphones on the battlefield



Juggernaut.Case™ is a registered trademark of Juggernaut Defense, LLC
www.JuggernautCase.com
©2016, Rev. A, US Patents Pending

Juggernaut.Case™

HAHO-L Mount Installation, Removal, & Accessories



installation

1

align HAHO-L mount with top of PALS mount



2

snap mount into place by pushing tabs on bottom of mount



removal

3

pull on the mount tabs to remove HAHO-L mount



4

rotate up and out of place



5

supplied tool kit for mount



6

using hex tool remove screw from PALS mount



7

replace screw with knob and tighten into existing nut



8

mount w/ attachments

Juggernaut.Case™

smartphones on the battlefield



Juggernaut.Case™ is a registered trademark of Juggernaut Defense, LLC
www.JuggernautCase.com
 ©2016, Rev. A, US Patents Pending